

Part number

CDSM 18



Brief description:

male insert, 18 poles + PE, spring terminal connections , 10A 400V, 6kV, 3, silver plated, size "57.27", CLASS insert series

Product description		Approvals / Standards	
Model	male insert	Reference standard	EN 61984 (2001-11)
Version	spring terminal connections	Quality mark	EAC
Series	CDS	Conformity	CQC, CE
Product type	with male contacts	General ordering information	
Family	CLASS inserts	EAN13 code	8015747148504
Size	size "57.27"	Tariff number	85369095
N. of poles	18 poles +	Country of origin	Made in EU (IT)
Technical data		ETIM classification	EC000438
Current	10 A (A.C. and D.C.)	Packaging Information	
Voltage	400 V	Packaging length	210,00 mm
Rated impulse withstand voltage	6kV	Packaging height	130,00 mm
Pollution degree	3	Packaging width	240,00 mm
Wire cross-section	0,14 mm ² - 2,50 mm ²	Packaging weight	1,08 kg
AWG size	26 - 14	Packaging volume	6,55 dm ³
Operating temperature range (min, max)	-50°C ... +70°C	Packaging description	Carton box
Contact type	silver plated	Packaging quantity	30 Pcs
Mating cycles	≥ 200	Packaging EAN code	8015747152396
IP degree of protection	IP20 without enclosure; IP65/IP66/IP67/IP68 with enclosure	Sub-packaging weight	0,18 kg
PE wire cross-section	0,14 - 4 mm ² ; AWG 20 - 12	Sub-packaging description	Carton
Further technical details		Sub-packaging quantity	5 Pcs
Characteristics according to EN 61984	10A 400V 6kV 3; 10A 400/690V 6kV 2	Sub-packaging EAN barcode	8015747152402
Insulation resistance	≥ 1 GΩ		
Rated voltage according to UL/CSA	600V		
UL 94 flammability rating	V-0		
Weight	36,00 g		

Part number

CDSM 18



Catalogue drawings

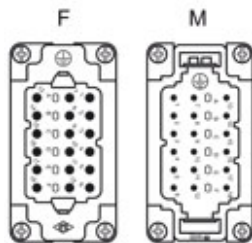
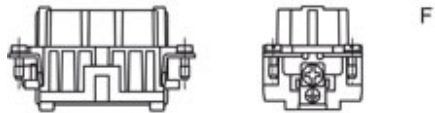
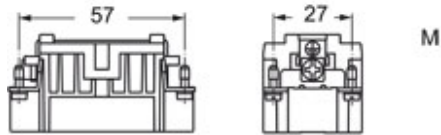

Notes

- characteristics according to EN 61984:
10A 400V 6kV 3
- insulation resistance: > 10 GOhm
- ambient temperature limit: -40 °C ... +125 °C
- made of self-extinguishing thermoplastic resin UL 94 V0
- mechanical life: > 500 cycles
- contact resistance: < 1 mOhm
- inserts for conductors section:
0.14 - 2.5 mm² - AWG 26 - 14
- for wires with crimped ferrule, usable section:
up to 1.5 mm² (AWG 16)
- conductors stripping length: 9...11 mm
- enclosures: size 57.27:
C-TYPE IP65/IP66
C7 IP67 stainless steel lever
V-TYPE IP65/IP66 stainless steel lever
T-TYPE IP65 insulating
JEI zinc-plated steel lever
BIG hoods
W-TYPE for aggressive environment
EMC
central lever
IP68
LS-TYPE
- panel supports: COB

Connection with spring terminal

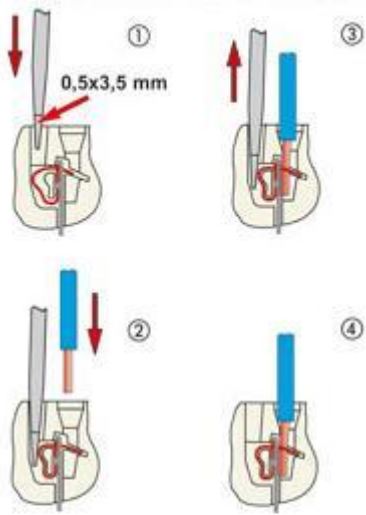

CR CDS coding pin
